

# EZstrip™ Cake Pump



The EZstrip Cake Pump is designed with a large auger inlet and screw conveyor. The screw conveyor extends to the compression area to help push the sludge cake into the cavities of the rotor and stator and provide consistent pumping.

## Benefits and Features

The range is available in cast iron, with a choice of rotor and stator materials and a variety of hopper sizes.

- Quick and easy to maintain in place
- Reduced maintenance downtime and labour savings
- No need to disconnect suction and discharge pipework, even when removing the screw conveyor
- Detachable feed chamber supplied as standard
- WIMES specification Efficiency 1 motors supplied as standard

## Capacity

Up to 215 gal/min (49m<sup>3</sup>/h)

## Pressure

Up to 350 psi (24 bar)

## Temperature

14°F up to 212°F (-10°C up to 100°C)

## Typical applications

Thickened sludge cake (upto 40% dry solids content), dewatered sludge, sludge blending, including lime powder dosing and lime slurry dosing in conjunction with barrier layer injection.

# EZstrip Cake Pump

To minimize the downtime and cost involved when maintaining a progressing cavity pump, the EZstrip Cake Pump can be fully maintained in place, without disconnecting pipework or removing the hopper.

Once the pumping elements have been disconnected, the middle support foot allows the feed chamber and rotor and stator to be turned, to assist removal of these parts. Alternatively, the complete assembly can be lifted out and returned to your workshop or bench for maintenance.

A full drive train including rotor, stator and screw conveyor can be removed in just 8 minutes using standard tools.

## Sludge Treatment Applications

- Blending
- Thickening
- Lime Slurry Dosing
- Dewatering
- Lime Powder Dosing
- Barrier Layer Injection
- Digestion

## Performance Data

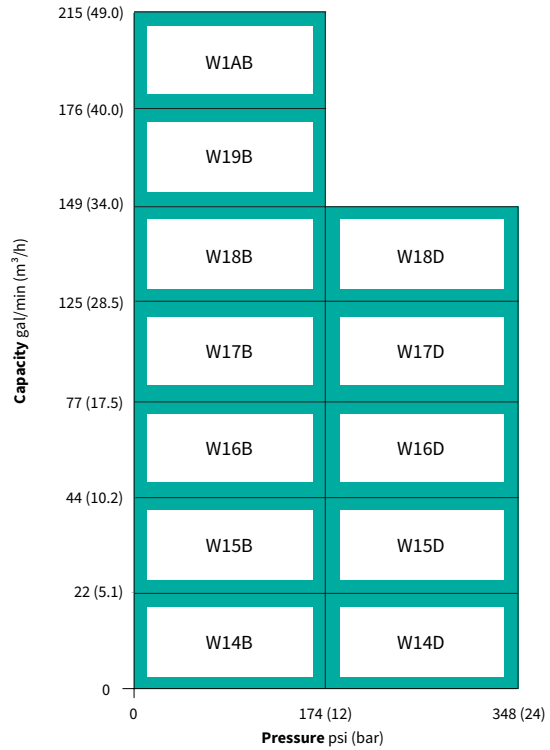

For higher flow rates and pressures, please contact NOV.

## Dimensions

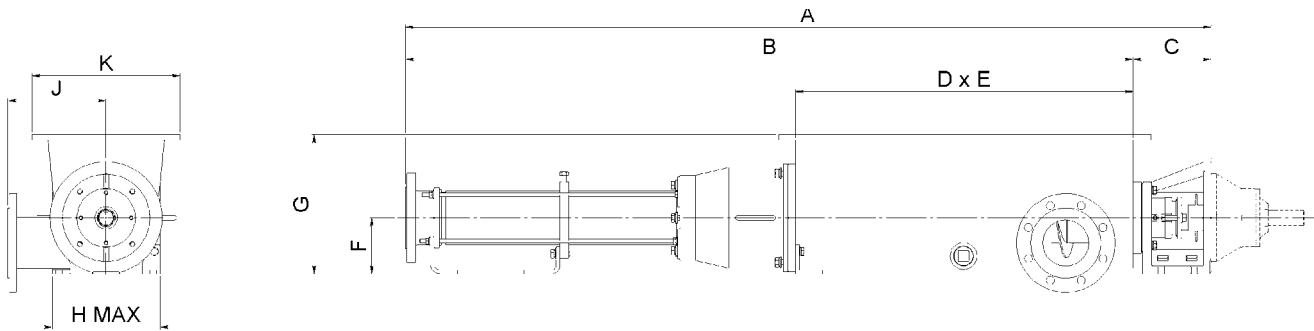

| MODEL | A (in/mm) |      | B (in/mm) |      | C (in/mm) |     | D (in/mm) |      | E (in/mm) |     | F (in/mm) |     | G (in/mm) |     | H (in/mm) |     | J (in/mm) |     | K (in/mm) |     |
|-------|-----------|------|-----------|------|-----------|-----|-----------|------|-----------|-----|-----------|-----|-----------|-----|-----------|-----|-----------|-----|-----------|-----|
| W14B  | 64.4      | 1636 | 57.7      | 1468 | 6.6       | 168 | 29.5      | 750  | 9.8       | 250 | 4.4       | 112 | 11.1      | 282 | 8.2       | 210 | 10.6      | 270 | 11.4      | 290 |
| W14D  | 82.0      | 2084 | 75.0      | 1907 | 6.9       | 177 | 29.5      | 750  | 9.8       | 250 | 4.9       | 125 | 11.6      | 295 | 8.2       | 210 | 10.6      | 270 | 11.4      | 290 |
| W15B  | 70.7      | 1797 | 63.8      | 1623 | 6.8       | 174 | 29.5      | 750  | 9.8       | 250 | 4.9       | 125 | 12.2      | 310 | 9.4       | 240 | 12.5      | 320 | 11.4      | 290 |
| W15D  | 93.9      | 2386 | 85.9      | 2182 | 8.0       | 204 | 29.5      | 750  | 9.8       | 250 | 5.9       | 150 | 13.1      | 335 | 9.4       | 240 | 12.5      | 320 | 11.4      | 290 |
| W16B  | 87.2      | 2216 | 79.2      | 2012 | 8.0       | 204 | 39.3      | 1000 | 14.1      | 360 | 5.9       | 150 | 14.7      | 375 | 11.4      | 290 | 12.5      | 320 | 15.7      | 400 |
| W16D  | 115.0     | 2923 | 105.9     | 2691 | 9.1       | 232 | 39.3      | 1000 | 14.1      | 360 | 6.2       | 160 | 15.0      | 382 | 11.4      | 290 | 12.5      | 320 | 15.7      | 400 |
| W17B  | 94.8      | 2410 | 86.6      | 2202 | 8.1       | 208 | 39.3      | 1000 | 14.1      | 360 | 6.8       | 175 | 16.3      | 415 | 13.1      | 335 | 12.5      | 320 | 15.7      | 400 |
| W17D  | 131.9     | 3352 | 121.6     | 3089 | 10.3      | 263 | 39.3      | 1000 | 14.1      | 360 | 8.8       | 225 | 18.3      | 465 | 13.1      | 335 | 12.5      | 320 | 15.7      | 400 |
| W18B  | 101.7     | 2584 | 92.2      | 2343 | 9.4       | 241 | 39.3      | 1000 | 14.1      | 360 | 8.8       | 225 | 19.8      | 505 | 15.1      | 385 | 13.7      | 350 | 15.7      | 400 |
| W18D  | 139.0     | 3533 | 128.6     | 3268 | 10.4      | 265 | 39.3      | 1000 | 14.1      | 360 | 8.8       | 225 | 19.8      | 505 | 15.7      | 400 | 13.7      | 350 | 15.7      | 400 |
| W19B  | 108.9     | 2768 | 99.8      | 2535 | 9.1       | 233 | 39.3      | 1000 | 14.1      | 360 | 8.8       | 225 | 19.8      | 505 | 16.9      | 430 | 13.7      | 350 | 15.7      | 400 |
| W1AB  | 122.0     | 3100 | 111.5     | 2834 | 10.4      | 266 | 39.3      | 1000 | 14.1      | 360 | 9.8       | 250 | 21.6      | 550 | 18.7      | 475 | 13.7      | 350 | 15.7      | 400 |

\* Can be supplied with either fixed speed inverter rated or mechanical variable speed drive.  
All dimensions in inches (millimeters) and for guidance only. For full certified drawings, please contact NOV.

